



LDM250 SONOMA



LDM250-90-BLP
Shown w/ [R] Mount

The **LDM250 Sonoma** directional marker is a high flux; low wattage LED luminaire. Coupled with a brass body, our Thermally Integrated® LED Module provides superior heat dissipation, longer life, and higher performance. It will provide subtle illumination on drives, walks, and pathways as an alternative to taller, more obvious fixtures. With five different illumination patterns, you are provided great versatility, and although designed as a small scale in-grade, it can also be mounted horizontally as a step light or wall-washer for artistic flair.

Features include:

- 3 Watts up to 65 Lumens
- Cree LED™ XLAMP® High Intensity (XP-L)
- 2700K (80 & 90 CRI), 3000K (80 CRI), 4000K (80 CRI), or Amber 585-595nm
- 12V Integral Constant Current Driver (Remote 12V AC/DC Transformer Required)
- Dimmable to <10% (TRIAC/Forward Phase) via Compatible Transformer
- Compatible w/ 12V AC/DC MLV or ELV Transformers
- Drive-over Rated up to 6,000 lbs. with Micro J-Box Accessory
- Solid Brass Construction

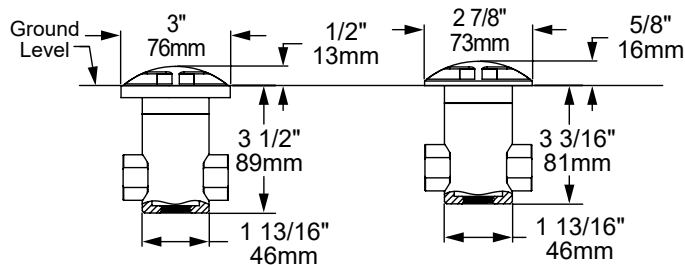
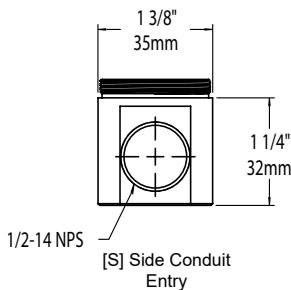
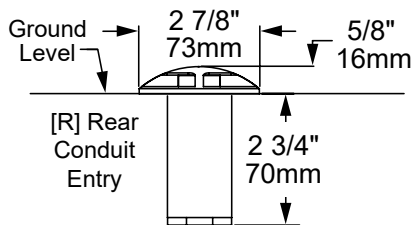

[MJB] Micro J-Box w/
[FM] Flush Mount

[MJB] Micro J-Box

BEAM PATTERNS

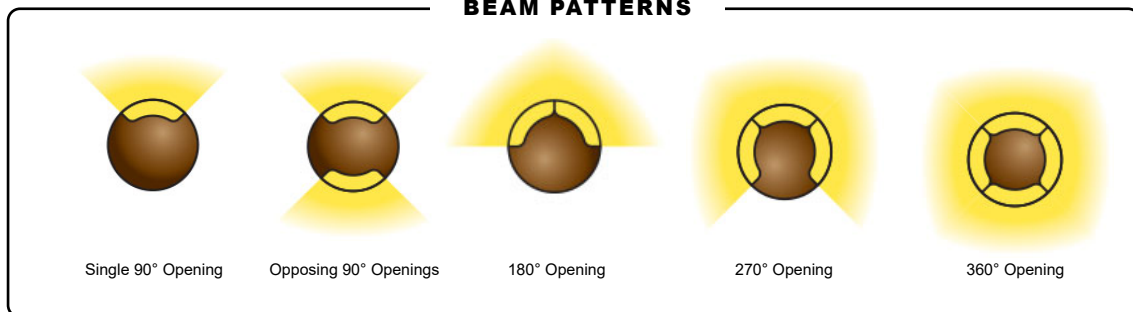

SEE NEXT PAGE FOR ORDERING INFORMATION

LDM250 SONOMA



ORDERING GUIDE: **LDM250** ^{Prefix} L (LED) DM (DIRECTIONAL MARKER) 250 (SERIES)

□ INDICATES REQUIRED FIELD

□ INDICATES OPTIONAL FIELD

✓ INCLUDED IN BASE PRICE

[_] QUICK SPEC (See Below)

QUICK SPEC SKU **LDM250-180-27-C-R-NAT**

LDM250

BEAM PATTERN ✓

- [90]** Single 90° Opening
- [90-2]** Opposing 90° Openings
- [180]** 180° Opening
- [270]** 270° Opening
- [360]** 360° Opening

LED COLOR ✓

- [27]** 2700K, 80 CRI
- [279]** 2700K, 90 CRI
- [30]** 3000K, 80 CRI
- [40]** 4000K, 80 CRI
- [AMB]** Amber (585-595 nm)

NOTE: For other CCT and CRI options, contact factory

MOUNT

- [R]** Rear Conduit Entry w/(1) 1/2" Rear Knockout ✓
- [S]** Side Conduit Entry w/(1) 1/2" Side Knockout
- [MJB]** Micro J-Box w/(2) 1/2" Side and (1) 1/2" Rear Knockout
- [MJB-FM]** Micro J-Box w/ Flush Mount*

*Recommended for wall mount installations. New construction only.

FINISH

- STANDARD:
- [NAT]** Natural ✓
- PLUS (\$):
- [BLP]** Bronze Living Patina
- [BLP-XD]** BLP Extra Dark
- PREMIUM (\$\$\$):
- [NI]** Nickel PVD
- [BG]** Black Gloss PVD
- [BS]** Black Satin PVD
- [BZ]** Bronze PVD
- [BZ-XD]** Dark Bronze PVD
- [PC]** Powder Coat Custom Color (Contact Factory for Color Options)

MOUNTS



[R] Rear Conduit



[S] Side Conduit



[MJB] Micro J-Box



[MJB-FM] Micro J-Box w/ Flush Mount

LDM250 SONOMA

PHOTOMETRIC OVERVIEW

Information based on 2700K. To download more in-depth IES photometric data, visit auroralight.com/product/lm250-sonoma/

2700K 90° BEAM PATTERN

17.96 LUMENS • CBCP 24 • BUG B0 U1 G0
AURORALIGHT LDM250-90-27

16 FT	0.00297	35.4
14 FT	0.00389	31.0
12 FT	0.00529	26.6
10 FT	0.00762	22.1
8 FT	0.00119	17.7
6 FT	0.0212	13.3
4 FT	0.0476	8.85
Distance From Fixture	Footcandles	Beam Width

3000K 180° BEAM PATTERN

38.47 LUMENS • CBCP 23 • BUG B0 U1 G0
AURORALIGHT LDM250-180-30

16 FT	0.00299	71.3
14 FT	0.00391	62.4
12 FT	0.00532	53.5
10 FT	0.00767	44.6
8 FT	0.0120	35.7
6 FT	0.0213	26.7
4 FT	0.0479	17.8
Distance From Fixture	Footcandles	Beam Width

3000K 270° BEAM PATTERN

24.57 LUMENS • CBCP 14 • BUG B0 U1 G0
AURORALIGHT LDM250-270-30

16 FT	0.00161	100
14 FT	0.00211	87.8
12 FT	0.00287	75.3
10 FT	0.00413	62.7
8 FT	0.00646	50.2
6 FT	0.0115	37.6
4 FT	0.0258	25.1
Distance From Fixture	Footcandles	Beam Width

4000K 360° BEAM PATTERN

65.76 LUMENS • CBCP 21 • BUG B0 U2 G0
AURORALIGHT LDM250-360-40

16 FT	0.00868	52.7
14 FT	0.0113	46.1
12 FT	0.0154	39.5
10 FT	0.0222	33.0
8 FT	0.0347	26.4
6 FT	0.0617	19.8
4 FT	0.139	13.2
Distance From Fixture	Footcandles	Beam Width