



Signature Series
Classic Auroralight



LDM350-90-BLP
Shown w/ [R] Mount

LDM350 SONOMA

The **LDM350 Sonoma** directional marker is a high flux; low wattage LED luminaire. Coupled with a brass body, our Thermally Integrated® LED Module provides superior heat dissipation, longer life, and higher performance. It will provide subtle illumination on drives, walks, and pathways as an alternative to taller, more obvious fixtures. With five different illumination patterns, you are provided great versatility, and although designed as a small scale in-grade, it can also be mounted horizontally as a step light or wall-washer for artistic flair.

Features include:

- 4 Watts up to 63 Lumens
- Cree LED™ XLAMP® Extreme High Power (XHP)
- 2700K (80 & 90 CRI), 3000K (80 CRI), 4500K (80 CRI), or Amber 585-595nm
- 12V Integral Constant Current Driver (Remote 12V AC/DC Transformer Required)
- Dimmable to <10% (TRIAC/Forward Phase) via Compatible Transformer
- Compatible w/ 12V AC/DC MLV or ELV Transformers
- Drive-over Rated up to 6,000 lbs. with Micro J-Box Accessory
- Solid Brass Construction

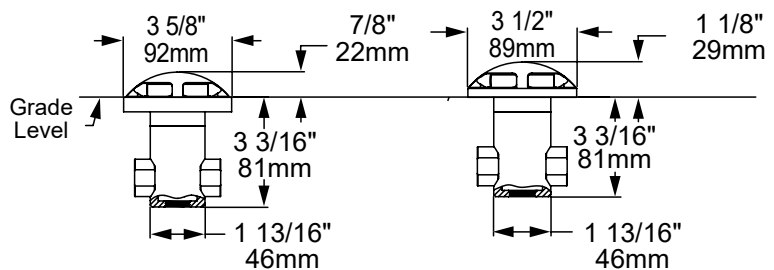
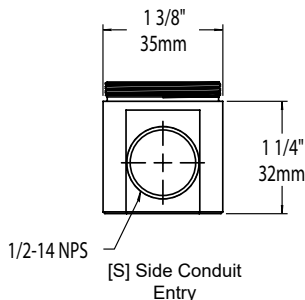
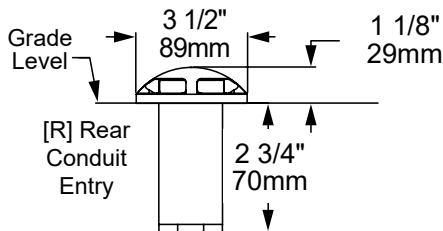

[MJB] Micro J-Box w/
[FM] Flush Mount

[MJB] Micro J-Box

BEAM PATTERNS

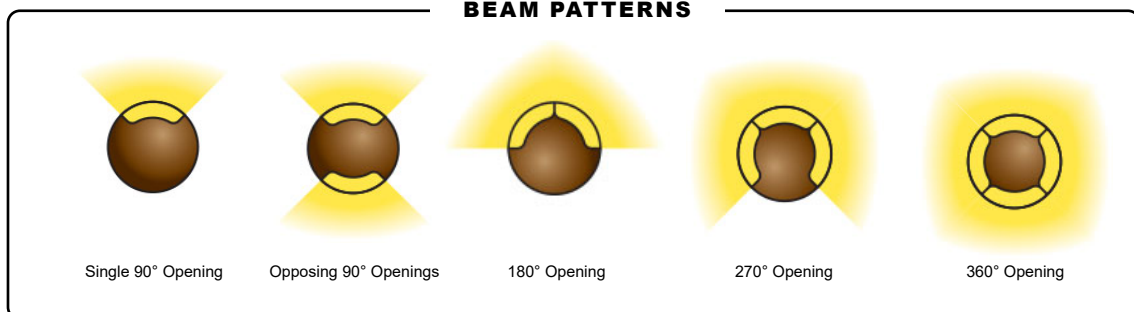

12V



THERMALLY
INTEGRATED

CREE
LED
POWERED



SEE NEXT PAGE FOR ORDERING INFORMATION



LDM350 SONOMA

ORDERING GUIDE: **LDM350** ^{Prefix} L (LED) DM (DIRECTIONAL MARKER) 350 (SERIES)

□ INDICATES REQUIRED FIELD □ INDICATES OPTIONAL FIELD ✓ INCLUDED IN BASE PRICE [_] QUICK SPEC (See Below)

QUICK SPEC SKU LDM350-180-27-C-R-NAT

LDM350					
BEAM PATTERN ✓	LED COLOR ✓	LENS ✓	MOUNT	FINISH	
[90] Single 90° Opening	[27] 2700K, 80 CRI	[F] Frosted	[R] Rear Conduit Entry w/(1) 1/2" Rear Knockout ✓	STANDARD:	
[90-2] Opposing 90° Openings	[279] 2700K, 90 CRI	[C] Clear	[S] Side Conduit Entry w/(1) 1/2" Side Knockout	[NAT] Natural ✓	
[180] 180° Opening	[30] 3000K, 80 CRI		[MJB] Micro J-Box w/(2) 1/2" Side and (1) 1/2" Rear Knockout	PLUS (\$):	
[270] 270° Opening	[45] 4500K, 80 CRI		[MJB-FM] Micro J-Box w/ Flush Mount*	[BLP] Bronze Living Patina	
[360] 360° Opening	[AMB] Amber (585-595 nm)			[BLP-XD] BLP Extra Dark	
	NOTE: For other CCT and CRI options, contact factory			PREMIUM (\$\$\$):	
				[NI] Nickel PVD	
				[BG] Black Gloss PVD	
				[BS] Black Satin PVD	
				[BZ] Bronze PVD	
				[BZ-XD] Dark Bronze PVD	
				[PC] Powder Coat Custom Color (Contact Factory for Color Options)	

MOUNTS



[R] Rear Conduit



[S] Side Conduit



[MJB] Micro J-Box



[MJB-FM] Micro J-Box w/ Flush Mount

LDM350 SONOMA

PHOTOMETRIC OVERVIEW

Information based on 3000K. To download more in-depth IES photometric data, visit auroralight.com/product/ldm350-sonoma/

3000K 90° BEAM PATTERN

16.81 LUMENS • CBCP 22 • BUG B0 U1 G0

AURORALIGHT LDM350-90-30

16 FT	0.00273	32.9
14 FT	0.00356	28.8
12 FT	0.00485	24.6
10 FT	0.00698	20.5
8 FT	0.0109	16.4
6 FT	0.0194	12.3
4 FT	0.0436	8.21
Distance From Fixture	Footcandles	Beam Width

3000K 180° BEAM PATTERN

34.66 LUMENS • CBCP 22 • BUG B0 U1 G0

AURORALIGHT LDM350-180-30

16 FT	0.00123	84.9
14 FT	0.00161	74.3
12 FT	0.00219	63.7
10 FT	0.00316	53.1
8 FT	0.00493	42.5
6 FT	0.00876	31.9
4 FT	0.0197	21.2
Distance From Fixture	Footcandles	Beam Width

3000K 270° BEAM PATTERN

50.92 LUMENS • CBCP 23 • BUG B0 U2 G0

AURORALIGHT LDM350-270-30

16 FT	0.00274	70.1
14 FT	0.00358	61.3
12 FT	0.00487	52.5
10 FT	0.00702	43.8
8 FT	0.0110	35.0
6 FT	0.0195	26.3
4 FT	0.0439	17.5
Distance From Fixture	Footcandles	Beam Width

4500K 360° BEAM PATTERN

63.61 LUMENS • CBCP 23 • BUG B0 U2 G0

AURORALIGHT LDM350-360-45

16 FT	0.162	33.0
14 FT	0.0719	28.9
12 FT	0.0405	24.7
10 FT	0.0259	20.6
8 FT	0.0180	16.5
6 FT	0.0132	12.4
4 FT	0.0101	8.24
Distance From Fixture	Footcandles	Beam Width