



LWW-3-NI



LWW-1-BLP-XD



LWW-2-NAT

The innovative **LWW Wallie** series wall wash luminaire is compact, powerful, and agile. It features precision-machined acrylic optics with a deep prismatic design that allows for a uniform 125° distribution from a single optic. Linear applications are supported via the 2 and 3 optic versions. With each optic being splayed away from the adjacent lens, 140°+ distribution is possible. This low-profile fixture is easily hidden among plantings and other landscape features, but the effect is dramatic and inviting.

Features include:

- 3, 4 or 7 Watts and up to 249 Lumens
- Cree LED™ XP-L® High Density
- 2700K (80 or 90 CRI), 3000K (80 CRI), 4500K (80 CRI), or Amber (585-595nm)
- Thermally Integrated®
- 12V Integral Constant Current Driver (Remote 12V AC/DC Transformer Required)
- Dimmable to <10% (TRIAC/Forward Phase) via Compatible Transformer
- Compatible w/ 12V AC/DC ELV or MLV Transformers
- Solid Brass Construction
- US Patent No: D838,398 S

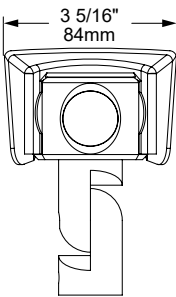

[1] Single Front View

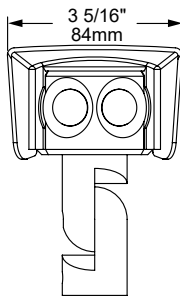

[2] Double Front View

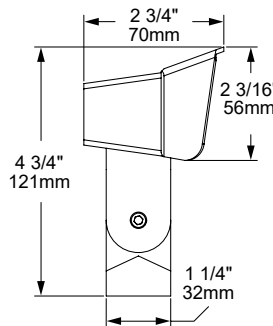

Single & Double Side View

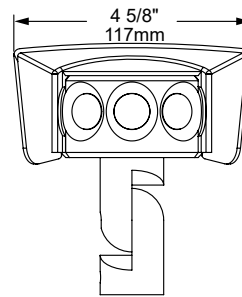

[3] Triple Front View

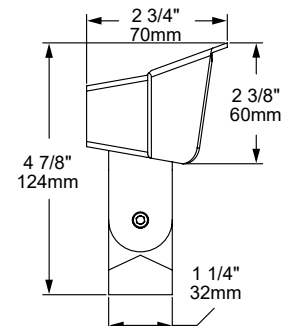

[3] Triple Side View

COPPER CORE TECHNOLOGY®

Copper Core® is a registered trademark of Auroralight. It is synonymous with the mark of quality and integrity. It means that our products are built upon a superior foundation of Solid Copper, ensuring every critical part functions seamlessly together Thermally integrated® one component to the next. Auroralight manufactured without compromise, engineered with passion, in the USA.

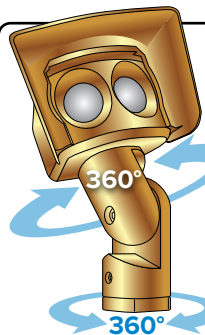

The Aurora Mount System (AMS™) features 2 axis of adjustment – 360° of fixture rotation at the mount and 230° at the solid brass knuckle. The ultimate in precision aiming without twisting or compromising wire integrity.



12V

THERMALLY
INTEGRATED

CREE
LED
POWERED

SEE NEXT PAGE FOR ORDERING INFORMATION



ORDERING GUIDE: **LWW** L (LED) W (WALL) W (WASHER)

INDICATES REQUIRED FIELD

INDICATES OPTIONAL FIELD

INCLUDED IN BASE PRICE

QUICK SPEC (See Below)

QUICK SPEC SKU LWW-2-27-AGS-NAT

LWW

LIGHT SOURCE

- [1] Single Optic (3 Watts) ✓
- [2] Double Optics (4 Watts)
- [3] Triple Optics (7 Watts)

LED COLOR ✓

- [27] 2700K, 80 CRI
- [279] 2700K, 90 CRI
- [30] 3000K, 80 CRI
- [45] 4500K, 80 CRI
- [AMB] Amber (585-595nm)

NOTE: For other CCT and CRI options, contact factory

RISER

EXTENDABLE (EXTR):

- [5X10] 5x10"
- [7X14] 7x14"
- [9X18] 9x18"
- [11X22] 11x22"
- [18X36] 18x36"

SUBTERRANEAN (EXTENDABLE):

(Mounts are not applicable with STR)

- [STR-12] 12" above grade 13 1/2" below
- [STR-18] 18" above grade 19 1/2" below

FIXED:

- [FR-4] 4"
- [FR-8] 8"
- [FR-12] 12"
- [FR-16] 16"
- [FR-18] 18"

90° & TEE OPTIONS:

Add **-90** (for 90°) or **-T** (for Tee) to any of the riser part numbers above.

NOTE: Risers are not compatible with AMS Mounts.

MOUNT

NO MOUNT:

- [1/2] 1/2" (NPS) Universal Thread ✓

GROUND:

- [AGS] AMS Ground Stake
- [BMS] Brass Micro Spike
- [2GS] Ground Stake w/ 2" Cap
- [3GS] Ground Stake w/ 3" Cap
- [325GS] Ground Stake w/ 3 1/4" Cap
- [DS] 9" Deluxe Spike
- [TR-12] 12" Trident Spike
- [JB3-S] 3" Junction Box w/ PVC Stake
- [PB-S] Power Box w/ PVC Stake Incl. w/ 60W 120-12V Trans.
- [PM-60-1] Concrete Pedestal Mount w/ 60W 120-12V Trans. (Single Hole/One Fixture)
- [PM-60-2] Concrete Pedestal Mount w/ 60W 120-12V Trans. (Double Hole/Two Fixtures)

TREE:

- [TS-HD-36] 36" AMS Tree Strap - Heavy Duty
- [BTM] Bolt-On Tree Mount
- [STM] Screw-In Tree Mount

SURFACE:

- [SMJB-1] Surface Mount J-Box (Single Hole/One Fixture) w/ 5 KO
- [SMJB-2] Surface Mount J-Box (Double Hole/Two Fixtures) w/ 5 KO
- [SM2] 2" Surface Mount
- [SM3] 3" Surface Mount
- [TM] AMS Trellis Mount
- [SB] AMS Splice Box

COVER PLATE:

- [CP35-BR] 3 1/2" Brass Cover Plate
- [CP14] 4" AMS J-Box Cover Plate
- [CP4-BR] 4" Brass Cover Plate
- [CP45-BR] 4 1/2" Brass Cover Plate
- [MC45-1] 4 1/2" Mount Canopy (Single Hole/One Fixture)
- [MC45-2] 4 1/2" Mount Canopy (Double Hole/Two Fixtures)
- [PC-60-1] 4 1/2" Power Canopy Incl. w/ 60W 120-12V Trans. (Single Hole/One Fixture)
- [PC-60-2] 4 1/2" Power Canopy Incl. w/ 60W 120-12V Trans. (Double Hole/Two Fixtures)

NOTE: Universal adapter included w/ fixture, except where AMS is noted. Most common configurations listed above; See Mount/Riser spec sheets for all options.

FINISH

STANDARD:

- [NAT] Natural ✓

PLUS (\$):

- [BLP] Bronze Living Patina
 - [BLP-XD] BLP Extra Dark
- PREMIUM (\$\$\$):
- [NI] Nickel PVD
 - [BG] Black Gloss PVD
 - [BS] Black Satin PVD
 - [BZ] Bronze PVD
 - [BZ-XD] Dark Bronze PVD

MOST POPULAR MOUNT OPTIONS



EXTR with 2GS



BMS



AGS



TS-HD

GROUND



BMS AGS 2GS DS TR JB3 PB PM

COVER PLATE



CP4 CP45 MC45 PC-60

EXTENDABLE



EXTR

SUBTERRANEAN (EXTENDABLE)

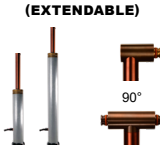

STR

FIXED



FR

SURFACE



SMJB-1 SMJB-2 SM2 SM3 TM SB

TREE



TS-HD BTM STM

PHOTOMETRIC OVERVIEW

To download more in-depth IES photometric data, visit auroralight.com/product/lww-wallie/

2700K 3W SINGLE OPTIC 129.8 LUMENS • CBCP 56 • BUG B0 U1 G0 AURORALIGHT LWW-1-27		
30 FT	0.0607	33.8
26 FT	0.0808	29.3
22 FT	0.113	24.8
18 FT	0.169	20.3
14 FT	0.279	15.8
10 FT	0.546	11.3
6 FT	1.52	6.75
Distance From Fixture	Footcandles	Beam Width

2700K 4 Watts DOUBLE OPTIC 170.7 LUMENS • CBCP 79 • BUG B0 U1 G0 AURORALIGHT LWW-2-30		
30 FT	0.0868	36.2
26 FT	0.116	31.4
22 FT	0.161	26.6
18 FT	0.241	21.7
14 FT	0.399	16.9
10 FT	0.781	12.1
6 FT	2.17	7.25
Distance From Fixture	Footcandles	Beam Width

3000K 7W TRIPLE OPTIC 249 LUMENS • CBCP 107 • BUG B0 U1 G0 AURORALIGHT LWW-3-30		
30 FT	0.118	37.1
26 FT	0.157	32.1
22 FT	0.220	27.2
18 FT	0.328	22.2
14 FT	0.543	17.3
10 FT	1.06	12.4
6 FT	2.96	7.41
Distance From Fixture	Footcandles	Beam Width