



HWM16-XO TELLURIDE

The newly redesigned **HWM16-XO Telluride** includes our Storm Drain™ lens drainage allowing water and dirt to wash away for optimal light transmission. Intended for use with open source MR16 sized LED lamps up to 8 Watts. The HWM16-XO is field convertible to our high performance LM16 "Designer Module" should the need arise. Offered in 2 versions: (LM, & XO) to meet the specific demands of our top tier customers. The HWM16 is specifically designed to install quickly. This luminaire is ideal for downlighting, directional lighting, and wall-washing, providing dramatic results.

Features include:

- Variety of LED Lamp Options
- 2700K 90 CRI), 3000K (CRI 90), or Turtle Safe Amber (560nm)
- Storm Drain™ Lens Drainage System
- Solid Brass Construction
- Compatible with 4, 6, 8 or 12 Watts "Designer LED module"

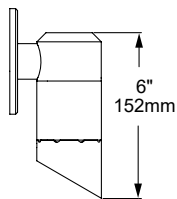
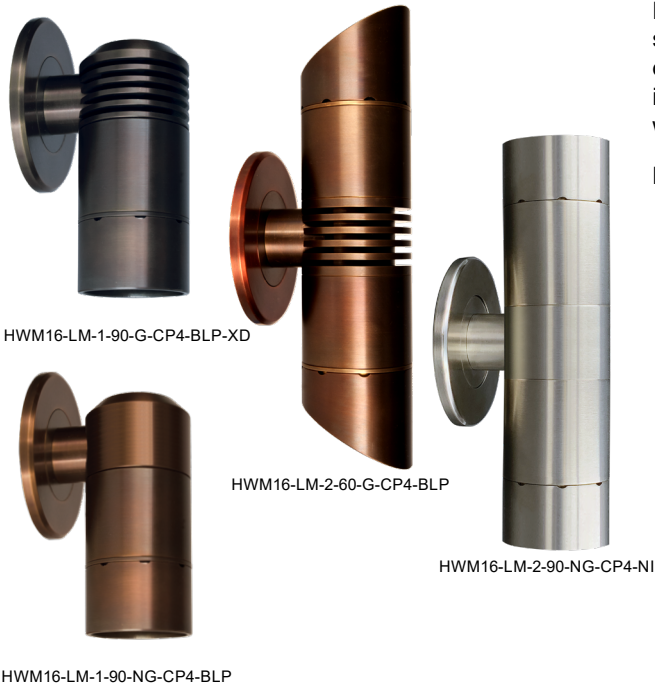

HWM16-1 [60°]
Angled Shield

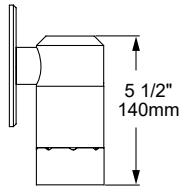

HWM16-1 [90°]
Straight Shield

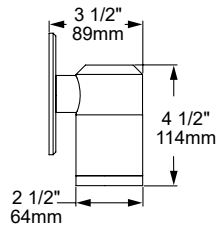

HWM16-1 [FS] Flush Shield

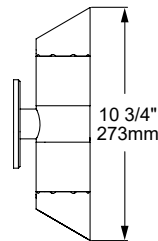

HWM16-2 [60°]
Angled Shields

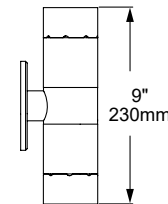

HWM16-2 [90°]
Straight Shields

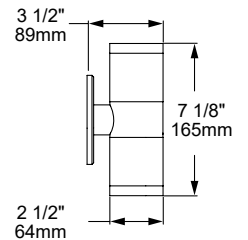

HWM16-2 [FS] Flush Shields





STORM DRAIN

Auroralight's proprietary Storm Drain™ system provides exceptional glare control together with enhanced drainage. The secret is our Exclusive "Linear Weep Hole". With eight or more such holes; water flushes out quickly and entirely with zero light trespasses. Auroralight, Engineering Solutions that make a difference!



12V

STORM DRAIN

SEE NEXT PAGE FOR ORDERING INFORMATION



HWM16-XO TELLURIDE

ORDERING GUIDE: ^{Prefix} **HWM16-XO** H (HIGH PERFORMANCE) WM (WALL MOUNT) 16 (SERIES) XO (NO LAMP)

□ INDICATES REQUIRED FIELD ◻ INDICATES OPTIONAL FIELD ✓ INCLUDED IN BASE PRICE [_] QUICK SPEC (See Below)

QUICK SPEC SKU **HWM16-XO-1-NG-50-7-W-27-ARW-H-CP4-BR-NAT**

