



H2O-P ARIEL



[NS] No Shield
H2O-P-NS-S-BLP-XD



[60°] Angled Shield
H2O-P-60-S-BLP-XD



[90°] Straight Shield
H2O-P-90-S-BLP-XD

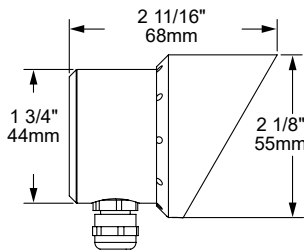

[60°] 60° Angled Shield

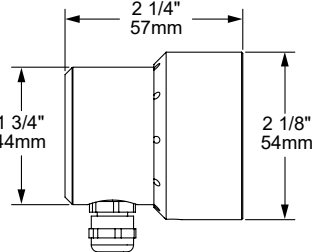

[90°] 90° Straight Shield

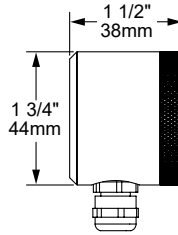

[NS] No Shield

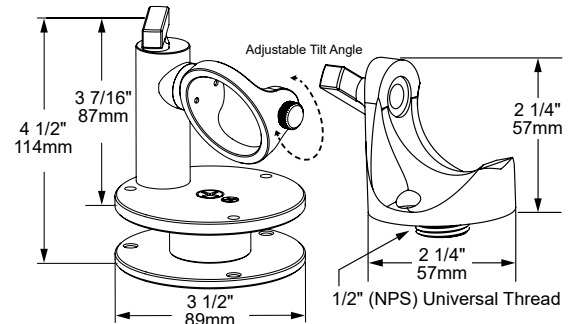

CAM-LOC Stand

Mount Bracket

The Auroralight **H2O-P Ariel** is an amphibious IP68, directional LED luminaire. With its compact size, the Ariel is perfect for smaller water features or hiding under aquatic plants or rocks. An innovative CAM-LOC™ Stand allows quick and secure, tool-less adjustment from above. Adding a spool kit provides stow space of slack cord for enhanced serviceability. When used on dry land the Storm Drain™ System keeps the lens spot-free.

Features include:

- IP68 LED Module in 4.5 Watts up to 335 Lumens
- Interchangeable PMMA Acrylic Optics from 20° to 75°
- 2700K (80 CRI) or 3000K (80 CRI)
- Thermally Integrated® w/ Copper Core Technology®
- Storm Drain™ Lens Drainage System
- 12V Integral Constant Current Driver (Remote 12V AC/DC Transformer Required)
- Dimmable to <10% (TRIAC/Forward Phase) via compatible transformer
- Compatible w/ 12V AC/DC MLV or ELV Transformers
- Solid Brass Construction

MOUNT OPTIONS



[CS-SK] Stand w/ Spool Kit



[CS] CAM-LOC Stand



[MB] Mount Bracket

COPPER CORE TECHNOLOGY®

Copper Core® is a registered trademark of Auroralight. It is synonymous with the mark of quality and integrity. It means that our products are built upon a superior foundation of Solid Copper, ensuring every critical part functions seamlessly together. Thermally integrated® one component to the next. Auroralight manufactured without compromise, engineered with passion, in the USA.



12V



SEE NEXT PAGE FOR ORDERING INFORMATION



ORDERING GUIDE: ^{Prefix} **H₂O-P** H₂O (UNDERWATER) P (PUCK)

☐ INDICATES REQUIRED FIELD
 ☐ INDICATES OPTIONAL FIELD
 ✓ INCLUDED
 [_] QUICK SPEC (See Below)

QUICK SPEC SKU **H2O-P-60-W-27-15-R-MB-NAT**

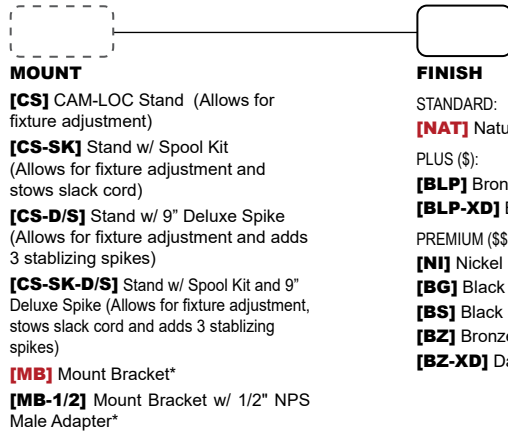
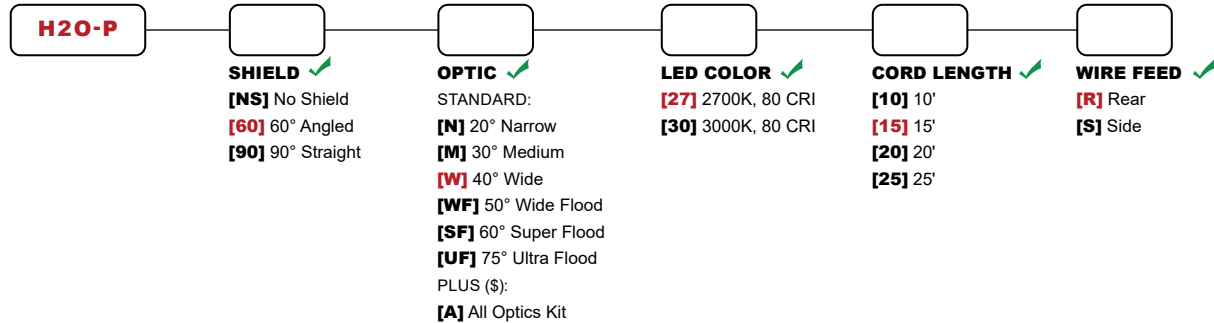

* Not compatible with [S] Side Wire Feed

MOUNTS



PHOTOMETRIC OVERVIEW

To download more in-depth IES photometric data, visit auroralight.com/product/h2o-p-ariel/

3000K 20° (NARROW) OPTIC No Shield 315.4 LUMENS • CBCP • BUG B0 U0 G0

AURORALIGHT H2O-P-N-30

30 FT	0.995	11.1
26 FT	1.32	9.60
22 FT	1.85	8.12
18 FT	2.76	6.64
14 FT	4.57	5.17
10 FT	18.95	3.69
6 FT	24.9	2.21
Distance From Fixture	Footcandles	Beam Width

3000K 50° (WIDE FLOOD) OPTIC No Shield 335.9 LUMENS • CBCP 430 • BUG B1 U0 G0

AURORALIGHT H2O-P-WF-30

30 FT	0.476	25.6
26 FT	0.634	22.2
22 FT	0.885	18.7
18 FT	1.32	15.3
14 FT	2.19	11.9
10 FT	4.29	8.52
6 FT	11.9	5.11
Distance From Fixture	Footcandles	Beam Width

3000K 75° (ULTRA FLOOD) OPTIC No Shield

298.0 LUMENS • CBCP 174 • BUG B0 U0 G0

AURORALIGHT H2O-P-UF-30

30 FT	0.192	36.1
26 FT	0.255	31.3
22 FT	0.357	26.5
18 FT	0.533	21.6
14 FT	0.881	16.8
10 FT	1.73	12.0
6 FT	4.80	7.22
Distance From Fixture	Footcandles	Beam Width