

AURORALIGHT

REQUIRED TOOLS:

3/32" Allen Key (Included)
Wire Cutter / Stripper

TAOS INSTALL GUIDE

UDW110244

INSTRUCTIONS:

1. To prevent electrical shock, disconnect transformer from electrical supply and make sure power supply is completely off before installation. Fixtures should always be installed by a licensed electrician.
2. Place the fixture with **CAM-LOC W/SPOOL KIT** in the desired wet or dry location.
3. Run the **2x 20AWG cable** to a dry location nearby. Separate the 2 internal conductors by stripping the large outer insulation first, then strip about ¼" off the end of each individual conductor (see figure).
4. Neatly wrap any excess cable around the base of the **spool kit**. Leave enough slack at the **fixture** to allow it to still rotate (see figure).
5. Connect the **20AWG wires** to the **main supply cable** using **UL listed connectors** suitable for underground and wet location as well as the appropriate UL listed underground feeder (UF) cable (see figure).
6. For light aiming, loosen the **wing nut** and rotate the **fixture** in the desired direction. Tighten the **wing nut** down when finished (see figure).

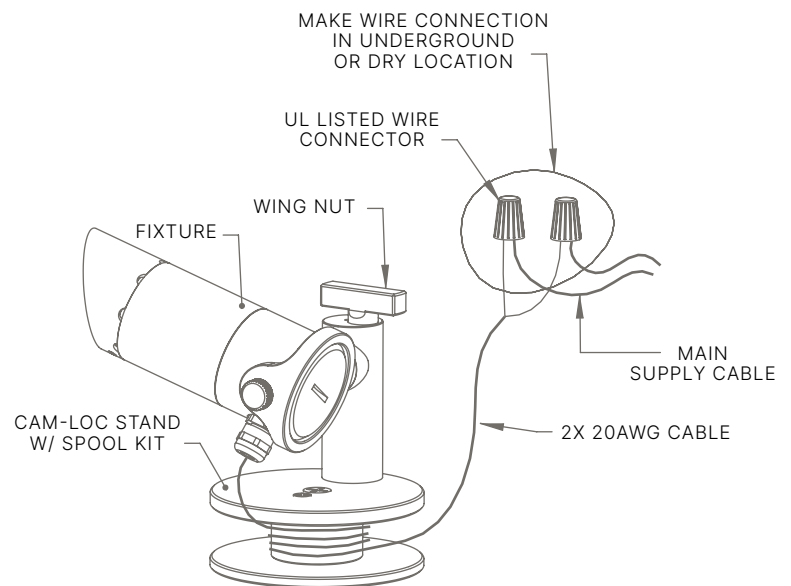

Important! This fixture is assembled and sealed at the factory, do not unscrew any of the pre-assembled caps or the cord seal. Doing so could result in leakage and failure.

P. 760.931.2910

E. techsupport@auroralight.com

O. 2742 Loker Ave. W Carlsbad CA 92010

W. www.auroralight.com

WARNING: Luminaire must be installed in accordance with local codes and the National Electrical Code (NEC). Failure to do so may result in serious injury and or damage to the luminaire.

WARNING: Risk of electric shock. Install per NEC Code 680.22(B (6), if listed low voltage luminaires are to be located near a pool, spa or fountain.